

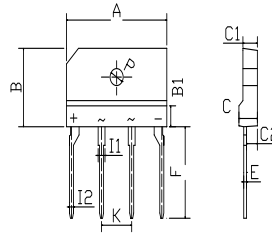

FEATURES

- Rating to 1000V PRV
- Surge overload rating to 170 Amperes peak
- Ideal for printed circuit board
- Reliable low cost construction utilizing molded plastic technique results in inexpensive product
- Lead solderable per MIL-STD-202 method 208



KBJ4		
Dim	Min	Max
A	24.80	25.20
B	14.80	15.20
B1	3.80	4.20
C	4.50	4.80
C1	3.50	3.80
C2	2.60	3.00
E	0.60	0.80
F	17.15	17.75
I1	1.55	1.85
I2	0.85	1.15
K	7.20	7.80
P	Ø3.25Typical	
All Dimensions in mm		

Maximum Ratings (@TA = 25°C unless otherwise specified)

Characteristic	Symbol	KBJ 6AA	KBJ 6BA	KBJ 6DA	KBJ 6GA	KBJ 6JA	KBJ 6KA	KBJ 6MA	UNITS
Maximum recurrent peak reverse voltage	V_{RRM}	50	100	200	400	600	800	1000	V
Maximum RMS voltage	V_{RMS}	35	70	140	280	420	560	700	V
Maximum DC blocking voltage	V_{DC}	50	100	200	400	600	800	1000	V
Maximum average forward Output current @T _C =110°C	$I_{F(AV)}$	6.0							A
Peak forward surge current 8.3ms single half-sine-wave superimposed on rated load	I_{FSM}	170							A
I ² t Rating for fusing @T _J =25°C	I ² t	120							A ² S

Thermal Characteristics

Characteristic	Symbol	KBJ 6AA	KBJ 6BA	KBJ 6DA	KBJ 6GA	KBJ 6JA	KBJ 6KA	KBJ 6MA	UNITS
Typical junction capacitance per element (NOTE1)	C_J	45							p F
Typical thermal resistance (NOTE2)	$R_{\theta JA}$ $R_{\theta JC}$	26 4.0							°C/W
Operating junction temperature range	T_J	- 55 ---- + 150							°C
Storage temperature range	T_{STG}	- 55 ---- + 150							°C

Electrical Characteristics (@TA = 25°C unless otherwise specified)

Characteristic	Symbol	KBJ 6AA	KBJ 6BA	KBJ 6DA	KBJ 6GA	KBJ 6JA	KBJ 6KA	KBJ 6MA	UNITS
Maximum instantaneous forward voltage @3.0A @6.0A	V_F	1.0 1.1							V
Maximum reverse current @T _A =25 °C at rated DC blocking voltage @T _A =125°C	I_R	5.0 0.5							μ A mA

NOTES: 1. Measured at 1.0MHZ and applied reverse voltage of 4.0V DC

2. Dev ice mounted on 300mm X 300mm X 1.6mm cu Plate heatsink.



FIG.1 – PEAK FORWARD SURGE CURRENT

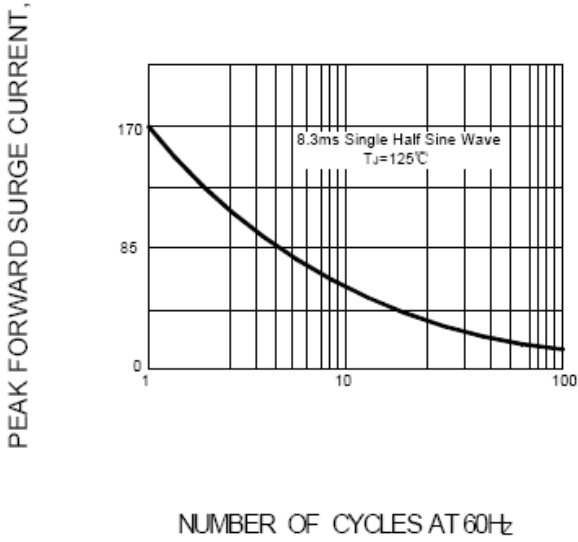

FIG.2 – FORWARD DERATING CURVE

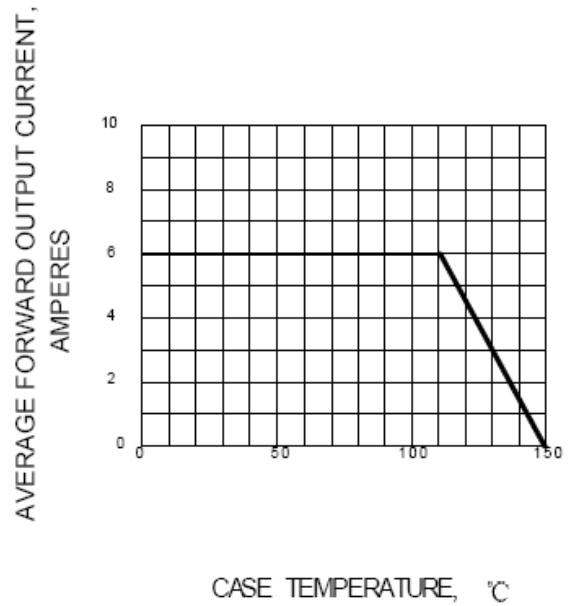

FIG.3 – TYPICAL FORWARD CHARACTERISTIC

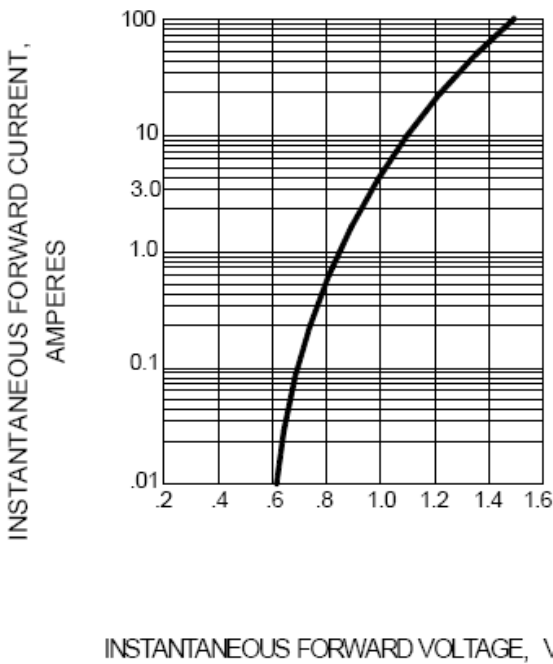
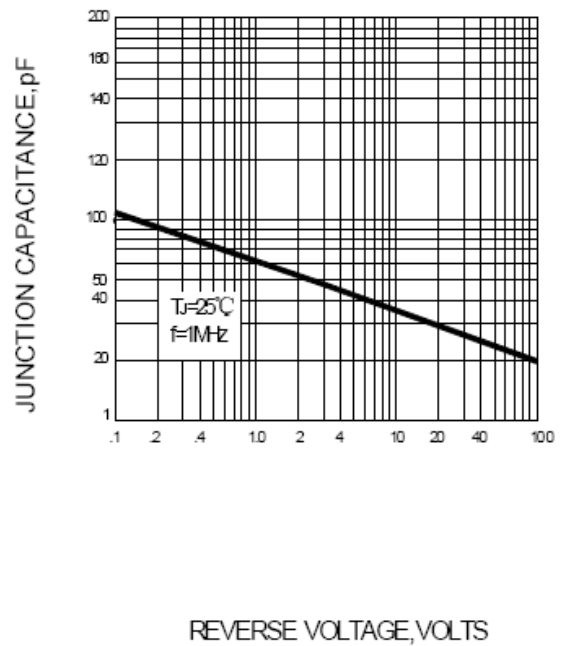

FIG.4 – TYPICAL JUNCTION CAPACITANCE



Device	Package	Shipping
KBJ6AA--KBJ6MA	KBJ4	250Units/Box